

Parts List:

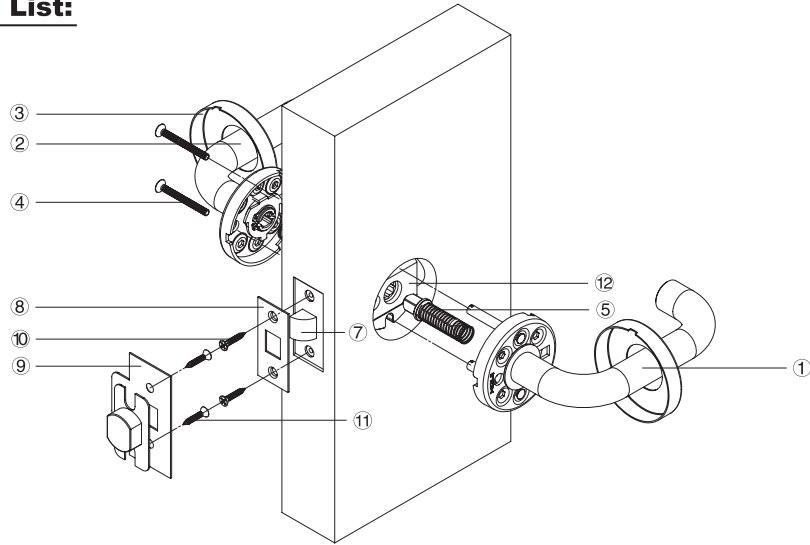

RA /SE with Tubular Latch
Installation Instructions

| Items | No. | Parts Description | Function | | | |
|----------------|-----|---|----------|---------|------------|------------|
| | | | Privacy | Passage | Full Dummy | Half Dummy |
| Leverset Parts | 1 | RA/SE Rose Outside w/Lever & Cover | 1 EA | 1 EA | 1 EA | 1 EA |
| | 2 | RA/SE Rose Inside w/Lever | 1 EA | 1 EA | 1 EA | - |
| | 3 | RA/SE Inside Rose Cover | 1 EA | 1 EA | 1 EA | - |
| | 4 | M4x1-3/8"(35mm) Machine Screw | 2 EA | 2 EA | 2 EA | - |
| | 5 | 8x1-3/4"(45mm) Spring Spindles | 2 EA | 2 EA | - | - |
| | 6 | Privacy Pin | 1 EA | - | - | - |
| | - | 8#x1" Wood Screws | - | - | 8 EA | 4 EA |
| Locks | 7 | Tubular Latch | 1 EA | 1 EA | - | - |
| | 8 | Tubular Latch Faceplate | 1 EA | 1 EA | - | - |
| | 9 | Tubular Latch Striking Plate | 1 EA | 1 EA | - | - |
| | 10 | 8# Screws for tubular latch faceplate | 2 EA | 2 EA | - | - |
| | 11 | Screws for tubular latch Striking Plate | 2 EA | 2 EA | - | - |
| | 12 | Latch Bracket | 1 EA | 1 EA | - | - |
| Others | - | Door Prep Template | 1 EA | 1 EA | 1 EA | 1 EA |
| | - | Installation Instruction | 1 EA | 1 EA | 1 EA | 1 EA |
| | - | Cleaning Tissue | 2 EA | 2 EA | 2 EA | 2 EA |

Change Latch Bolt Direction

TL2 Latch
45 degree retraction latch

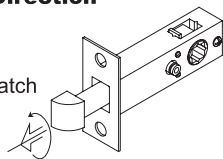

TL3 Latch
28 degree retraction latch

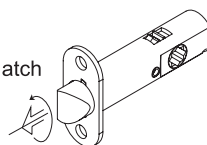

Take out the latch and turn 180°

Installation Steps

For Passage Function: L61

- 2.1) Install latch bracket, insert tubular latch, fixed with two #8 screws provided.
- 2.2) Insert outside spindle, mount outside lever with rose cover.
- 2.3) Insert inside spindle, mount two M4 screws into the screw holes on the top and bottom of the inside lever, through latch bracket, into the screw sleeves on the outside rose.
- 2.4) Mount inside rose cover.

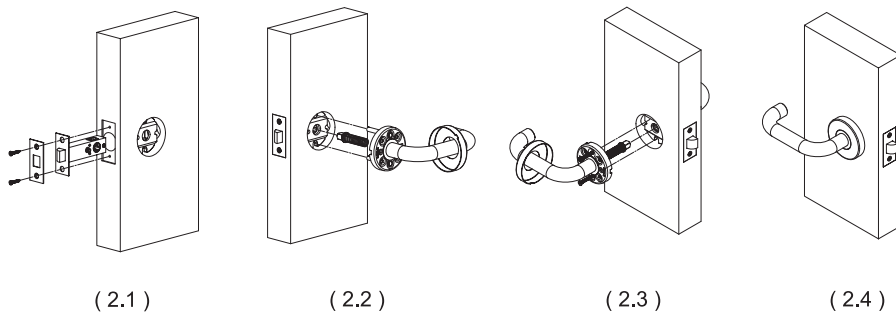

For Privacy Function: L62

- 1.1) Install latch bracket, insert tubular latch, fixed with two #8 screws provided.
- 1.2) Insert outside spindle, mount outside lever with rose cover.
- 1.3) Insert inside spindle, mount two M4 screws into the screw holes on the top and bottom of the inside lever, through latch bracket, into the screw sleeves on the outside rose.
- 1.4) Mount inside rose cover, tighten the pin into privacy hole on the tubular latch.

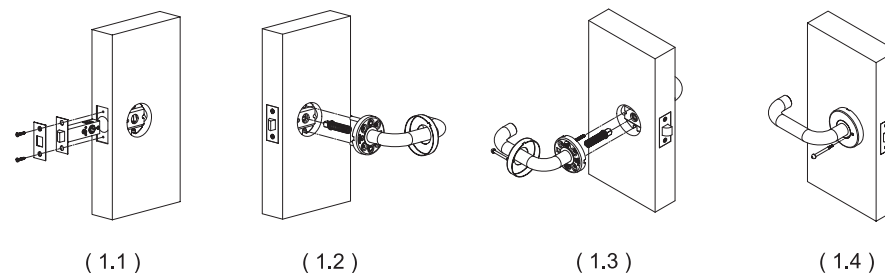

For Full Dummy and Half Dummy Function: DP & DL or DR

- 3.1) Mount outside lever, fix wood screws on inner rose.
- 3.2) Mount rose cover. (for half dummy and full dummy)
- 3.3) Mount inside lever, fix wood screws on inner rose.
- 3.4) Mount rose cover. (for full dummy)

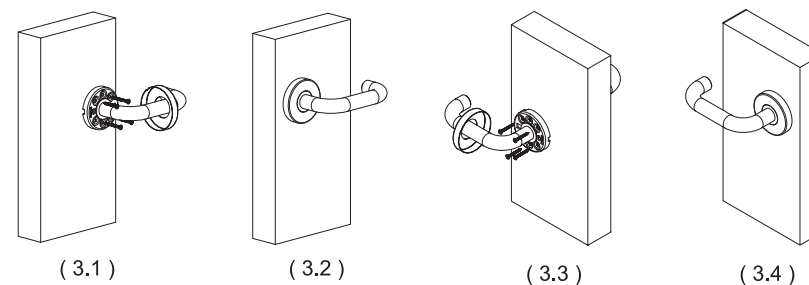

For Communicating Function: CM

- 4.1) Install latch bracket, insert tubular latch, fixed with two #8 screws provided.
- 4.2) Insert outside spindle, mount outside lever with rose cover.
- 4.3) Mount inside rose, insert two M4 screws into the screw holes on the top and bottom of the inside rose, through latch bracket, into the screw sleeves on the outside rose.
- 4.4) Mount inside rose cover.

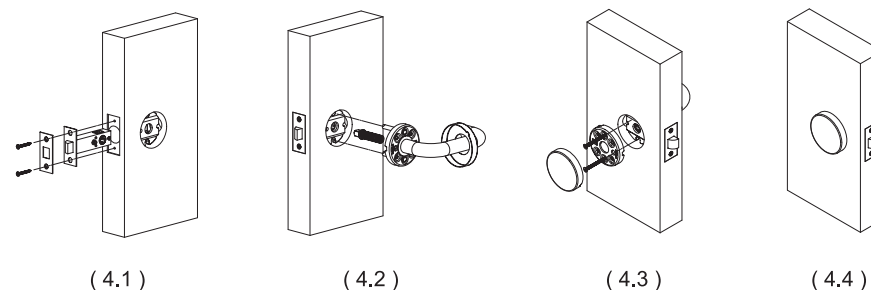

DP For Pre-bored Doors Function:

- 5.1) Install latch bracket, insert dummy latch, fixed with two #8 screws provided.
- 5.2) Mount outside lever with rose cover.
- 5.3) Mount two M4 screws into the screw holes on the top and bottom of the inside rose, through latch bracket, into the screw sleeves on the outside rose.
- 5.4) Mount inside rose cover.

